

YASKAWA

GA800 DRIVE

MANUAL SUPPLEMENT

AC DRIVE FOR INDUSTRIAL APPLICATIONS

AFFECTED DOCUMENTS:

- GA800 Installation & Primary Operation (TOEPC71061737)
- GA500 Technical Reference (SIEPC71061737)
- GA800 Quick Setup Procedure (TOEPC71061750)

PDF

yaskawa.com/TOEPYAISUP21

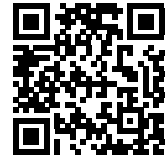

DOCUMENT NUMBER: TOEPYAISUP21

1 Supplemental Information - Applicable Documents

The contents of this supplement apply to the product instructions in [Table 1.1](#).

Table 1.1 Affected Documents

Drive Series	Document
GA800	GA800 Installation & Primary Operation (TOEPC71061737)
	GA800 Technical Reference (SIEPC71061737)
	GA800 Quick Setup Procedure (TOEPC71061750)

2 Terminal Block Dimensions

⚠ DANGER *Electrical Shock Hazard. Do not examine, connect, or disconnect wiring on an energized drive. Before servicing, disconnect all power to the equipment and wait for the time specified on the warning label at a minimum. The internal capacitor stays charged after the drive is de-energized. The charge indicator LED extinguishes when the DC bus voltage decreases below 50 Vdc. When all indicators are OFF, remove the covers before measuring for dangerous voltages to make sure that the drive is safe. If you do work on the drive when it is energized, it will cause serious injury or death from electrical shock.*

⚠ WARNING *Arc Flash Hazard. Obey local codes and Arc Flash safety requirements contained in the Standard for Electrical Safety in the Workplace NFPA 70E (2009 Edition or later) and the Workplace Electrical Safety, Canadian Standards Association (CSA) Z462-12. Obey safe work procedures and use applicable personal protective equipment (PPE). If you do not obey these requirements and procedures, it can cause serious injury or death.*

Use [Table 2.1](#) to find the correct terminal block dimension figure for the frame size of your drive.

Table 2.1 Drive Model and Frame Size Reference

Model	Frame Size	Reference Figure	
2257 2313	Frame 9	Figure 2.1	
2360 2415	Frame 10		
4208 4250 4302	Frame 9		
4371 4414	Frame 10		
4477 4568 4605 4720	Frame 11		
5289	Frame 10		
5382 5412 5472	Frame 11		
4810 4930 4H11 4H12	Frame 12		Figure 2.2

◆ Frames 9, 10, and 11 Terminal Block Dimensions

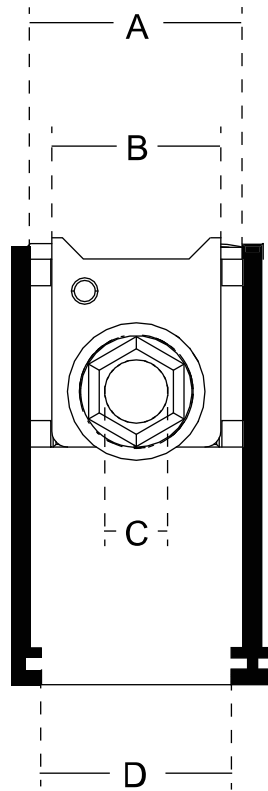

Figure 2.1 Frames 9, 10 and 11 Terminal Block Dimensions

Frame	Terminal	A	B	C	D
		Max Width between Barriers mm (in) ^{*1}	Contact Area Width mm (in) ^{*1}	Stud Diameter mm (in)	Opening Restriction Width mm (in) ^{*1}
9	R/L1, S/L2, T/L3	36 (1.4)	29 (1.1)	10 (0.4)	30 (1.2)
	U/T1, V/T2, W/T3	36 (1.4)	29 (1.1)	10 (0.4)	30 (1.2)
	-, +1	40 (1.6)	33 (1.3)	10 (0.4)	36 (1.4)
	+3	28 (1.1)	20 (0.8)	10 (0.4)	24 (0.9)
	⊕	-	100 (3.9)	10 (0.4)	-
10	R/L1, S/L2, T/L3	41 (1.6)	32 (1.3)	12 (0.5)	36 (1.4)
	U/T1, V/T2, W/T3	41 (1.6)	32 (1.3)	12 (0.5)	36 (1.4)
	-, +1	48 (1.9)	40 (1.6)	12 (0.5)	40 (1.6)
	+3	40 (1.6)	32 (1.3)	12 (0.5)	36 (1.4)
	⊕	-	116 (4.6)	12 (0.5)	-

2 Terminal Block Dimensions

Frame	Terminal	A	B	C	D
		Max Width between Barriers mm (in) */	Contact Area Width mm (in) */	Stud Diameter mm (in)	Opening Restriction Width mm (in) */
11	R/L1, S/L2, T/L3	41 (1.6)	32 (1.3)	12 (0.5)	36 (1.4)
	U/T1, V/T2, W/T3	38 (1.5)	34 (1.3)	12 (0.5)	34 (1.3)
	-, +1	45 (1.8)	40 (1.6)	12 (0.5)	40 (1.6)
	+3	37 (1.5)	35 (1.4)	12 (0.5)	35 (1.4)
	⊕	-	116 (4.6)	12 (0.5)	-

*1 Typical tolerances on dimensions are +0 mm/ -1.5 mm.

Note:

◆ Frame 12 Terminal Block Dimensions

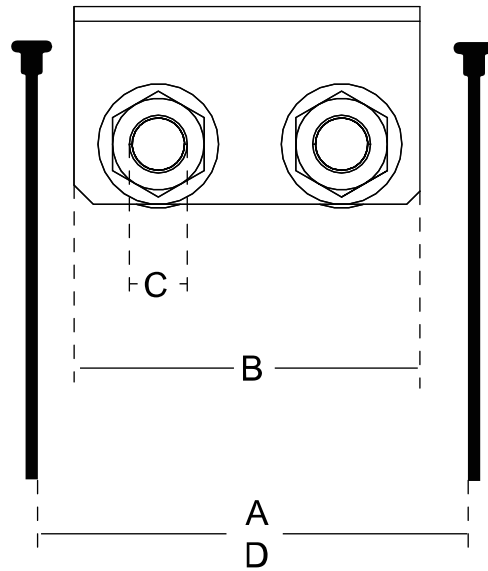

Figure 2.2 Frame 12 Terminal Block Dimensions

Frame	Terminal	A	B	C	D
		Max Width between Barriers mm (in) */	Contact Area Width mm (in) */	Stud Diameter mm (in)	Opening Restriction Width mm (in) */
12	R/L1, S/L2, T/L3 R/L11, S/L21, T/L31	77 (3.0)	73 (2.9)	12 (0.5)	77 (3.0)
	U/T1, V/T2, W/T3	77 (3.0)	73 (2.9)	12 (0.5)	77 (3.0)
	-, +1	77 (3.0)	73 (2.9)	12 (0.5)	77 (3.0)
	+3	77 (3.0)	73 (2.9)	12 (0.5)	77 (3.0)
	⊕	-	116 (4.6)	12 (0.5)	-

*1 Typical tolerances on dimensions are +0 mm/ -1.5 mm.

Revision History

Date of Publication	Revision Number	Revised Content
April 2024	-	First release

YASKAWA

GA800 DRIVE MANUAL SUPPLEMENT

YASKAWA AMERICA, INC.

2121, Norman Drive South, Waukegan, IL
60085, U.S.A.
Phone: +1-800-YASKAWA (927-5292) or +1-
847-887-7000 Fax: +1-847-887-7310
www.yaskawa.com

DRIVE CENTER (INVERTER PLANT)

2-13-1, Nishimiyaichi, Yukuhashi, Fukuoka,
824-8511, Japan
Phone: +81-930-25-2548 Fax: +81-930-25-
3431
www.yaskawa.co.jp

YASKAWA EUROPE GmbH

Philipp-Reis-Str. 6, 65795 Hattersheim am
Main, Germany
Phone: +49-6196-569-300 Fax: +49-6196-
569-398
E-mail: info@yaskawa.eu.com
www.yaskawa.eu.com

YASKAWA ELÉTRICO DO BRASIL LTDA.

777, Avenida Piraporinha, Diadema, São
Paulo, 09950-000, Brasil
Phone: +55-11-3585-1100 Fax: +55-11-3585-
1187
www.yaskawa.com.br

In the event that the end user of this product is to be the military and said product is to be employed in any weapons systems or the manufacture thereof, the export will fall under the relevant regulations as stipulated in the Foreign Exchange and Foreign Trade Regulations. Therefore, be sure to follow all procedures and submit all relevant documentation according to any and all rules, regulations and laws that may apply.

Specifications are subject to change without notice for ongoing product modifications and improvements.

Original Instructions

© 2024 YASKAWA AMERICA, Inc.

YASKAWA AMERICA, Inc.

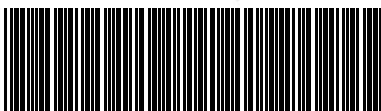

TOEPYAISUP21

TOEPYAISUP21
Revision: A <0>-
April 2024
Published in U.S.A.